

# Installing & Cutting Interstyle Glasstyle



Interstyle Ceramic & Glass Ltd.  
3625 Brighton Ave., Burnaby, BC Canada V5A 3H5  
Tel: 604 421-7229 / Fax: 604 421-7544  
[www.interstyle.ca](http://www.interstyle.ca) / [info@interstyle.ca](mailto:info@interstyle.ca)

Interstyle manufactures **Glasstyle** by fusing clear glass with ceramic glazes. **Glasstyle** may be installed on interior or exterior wall areas, in wet or dry locations (even in hot or cold environments). **Glasstyle** is manufactured in 4 and 6 mm thicknesses for wall use. *Glass differs from ceramic products, so extra caution and attention to installation instructions is recommended.* **Glasstyle** should not be exposed to high abrasion, high impact and thermal shock or installed over flexible surfaces.

## Substrate Preparation

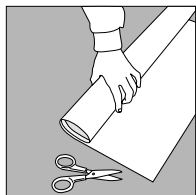

*Since any crack in a glass tile is very visible, the use of a crack isolation membrane (ANSI A118.12-2005) over the entire surface is strongly recommended. Many substrates may continue to cure and shrink over a period of months, and a crack isolation membrane prevents shrinkage or movement of the substrate to mirror through the tile. If a crack isolation membrane is not used, neither the distributor nor the manufacturer will accept any responsibility should any cracking occur.*

*Install only over well-cured, stable substrates.*

*Allow for an expansion joint whenever substrates change.*

## Installation

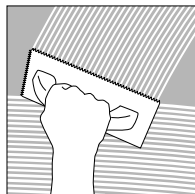

Use a white thin-set mortar (2-component, flexible, rapid cure, acrylic thin-set mortar system, such as Grani/Rapid by Mapei) formulated for interior and exterior wall installations. Spread the adhesive with a notched trowel following the manufacturer's recommendations (in many cases a 3/16" V-notch trowel works well).

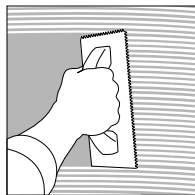

Use the flat side of the trowel to smooth the ridges without removing thin-set. **Use only the thin-set manufacturer's minimum recommended thickness of thin-set. Do not over-build the adhesive, as it will shrink and add stress or crack the glass.** Spread only as much adhesive as will be covered with the tile within 15 minutes.

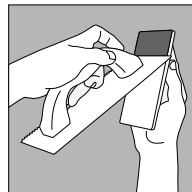

Sheet mounted mosaics can be applied directly to the thin-set. 4" and larger tiles should be "back buttered" with the flat edge of the trowel to provide a void-free installation and good contact with the mortar bed. Firmly press the glass against the surface to prevent voids in the adhesive from showing through the glass.

Install **Interstyle Glasstyle** on the wall leaving even spacing between tiles of at least 1/16" (1.5mm). Use plastic spacers whenever possible.

Install control joints where the tile abuts restraining surfaces and around the perimeter of the tile work.

Allow the adhesive to cure according to the manufacturer's instructions (at least 24 hours). Grout with an unsanded grout to prevent scratching of the surface. Grout joints should be filled to approximately 2/3 of the thickness of the tile to allow light to reflect on the internal surfaces of the tile.

## Cutting

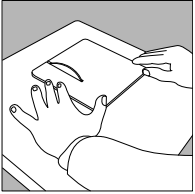

Glass tile should be cut on a wet saw using a diamond blade designed for cutting glass. A blade for cutting glass is thin, has smaller diamonds than a tile blade, has a continuous rim and generally runs at a slower speed. Glass tile is cut with the glazed side up, the rotation of the saw blade should enter the glass from the glazed side. Ensure adequate water or coolant is provided. Whenever possible cut edges should be placed in corners where they can be covered or hidden. Keep in mind that in many cases it may be easier and less expensive to mark your cuts and take the tile to a professional glass shop for cutting or drilling.

*Notes – A blade designed for cutting ceramic tiles is coarse and will chip the glass. Straight cuts generally do not result in additional stress to the glass tile, but notched cuts may add stress and cause cracking of the glass at the inside corner. A standard ceramic tile cutter is not recommended.*

Blades for cutting glass tiles are made to fit most tile saws and are available from many tile distributors. A lapidary blade will also cut glass tiles cleanly. Interstyle has developed an inex-

pensive 4" and 7" electroplated diamond blade for use with a wet saw. Contact your dealer to purchase these blades.

**Cutting Curves** – A ring or band saw designed for cutting glass makes cutting curves easy.

For wet and band saw information contact:

**Plasplugs** [www.plasplugs.com](http://www.plasplugs.com)

800-966-6400

**MK Diamond** [www.mkdiamond.com](http://www.mkdiamond.com)

800-845-3729

**Gemini Saw** [www.geminiaw.com](http://www.geminiaw.com)

310-891-0288

**Diamond Tech** [www.diamondsaws.com](http://www.diamondsaws.com)

800-937-9593

## Drilling

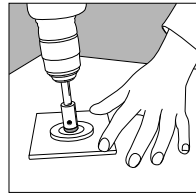

Drilling a hole requires the use of a drill bit or coring drill that is designed for glass – if the drill and glass tile cannot be securely clamped in place, drill a small pilot hole through the glass to act as a guide. Always use a proper glass drill bit, keep the drill bit and hole lubricated with turpentine or water and drill at very slow speed. Start drilling from the back of the tile, then complete the hole by drilling from the face of the tile. Attempting to drill all the way through

the tile from one side will cause the glass to chip off on the exit side of the hole. *Important – Drill a hole 1/8" (3mm) larger than any anchors you plan to use. This will prevent stress transfer from the fixture to the glass tile. Ensure anchors are well secured to the structure (not only to the substrate) and do not allow fixtures to rest directly on the glass.*

## Cleaning

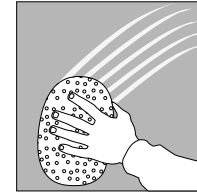

For routine cleaning, use any non-abrasive cleaning compound recommended for either glass or tile (such as ammonia and water, etc.). Follow rinsing instructions carefully.

A penetrating sealer may be used to facilitate clean up of cooking oils on frosted and textured glass.