

Cutting holes for receptacles

If glass is not drilled properly it can and will easily chip or break. Here is a guide on how to successfully cut glass



Use a high quality diamond coring bit



Use plenty of water for lubrication



Mark the area you will be drilling through



Use a wooden pattern to guide the coring bit



Drill on a stable surface

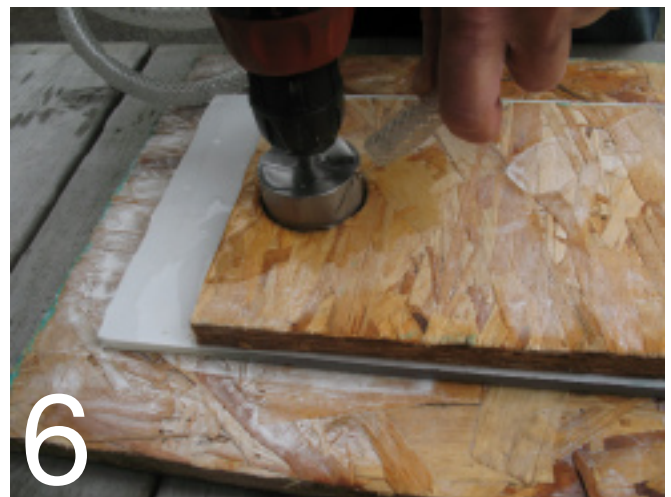

Drill at a slow speed with a water source lubricating the drill and glass



7
Superimpose a second hole to create an opening large enough to cover the recep-



8
Remove all glass pieces

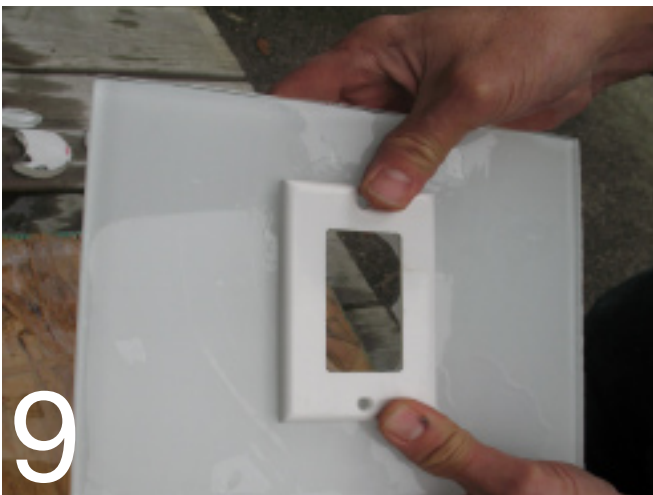

9
Insure the cutout is large enough



10
Install tile and receptacle



11
Replace cover plate